

All dimensions must be checked and confirmed on-site prior to commencement of construction and any inconsistencies to drawings discovered on site must be immediately brought to the attention of the Project Leader

The areas indicated on the drawing are approximate only and are our assessment using the currently available information. Any decisions made on the basis of these assessments, whether as to project viability, letting, lease agreements or similar must be based on dimensions measured by a registered surveyor.

Notes

1. All dimensions shown are in meters unless noted otherwise
2. Do not scale from this drawing
3. This drawing is to be read in conjunction with all relevant drawings and documents
4. Any queries should be directed to the Stansted delivery design team
5. This drawing is use for planning application only

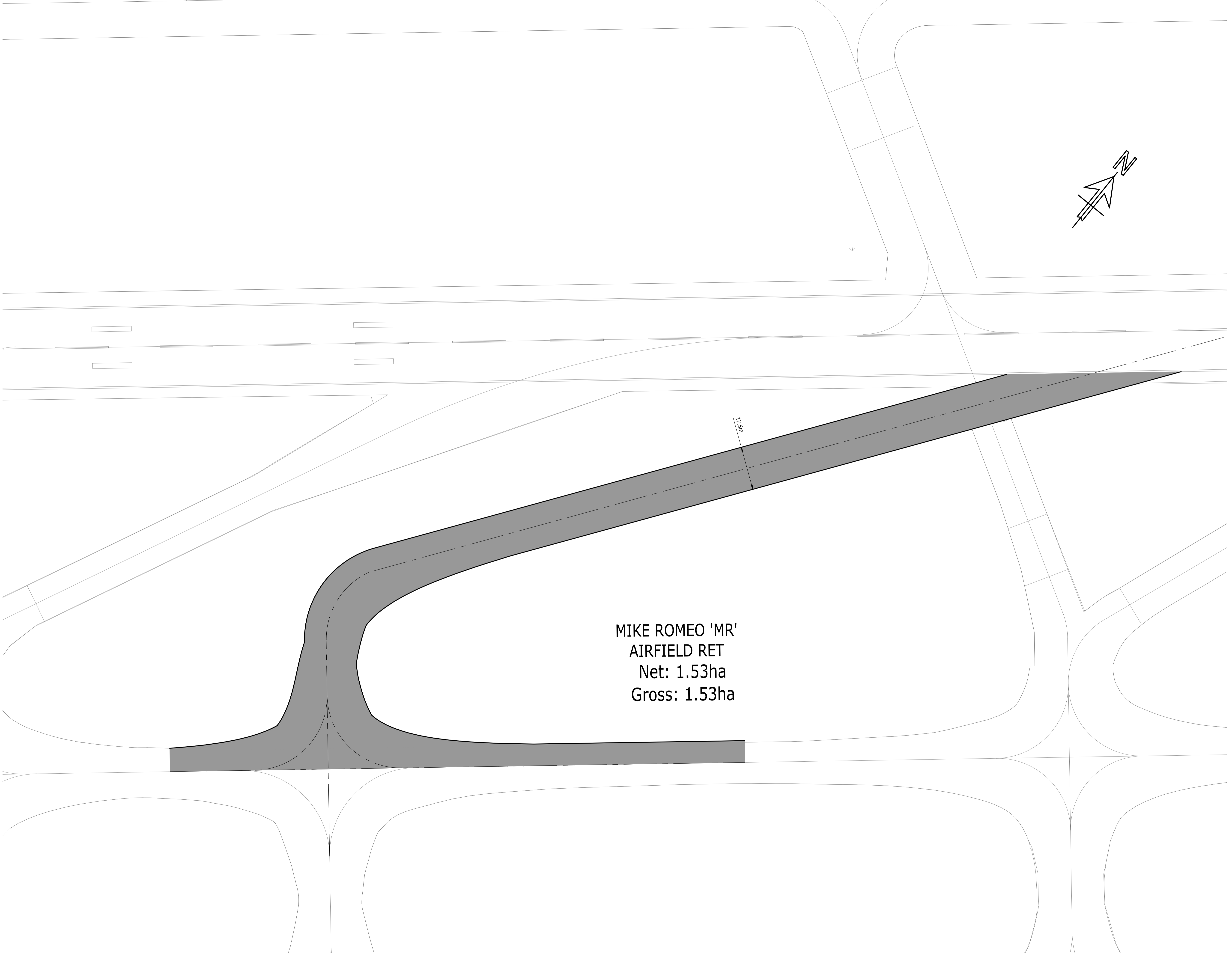
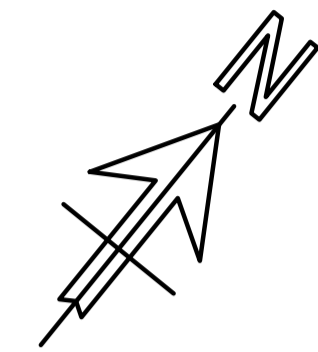

MIKE ROMEO 'MR'  
 AIRFIELD RET  
 Net: 1.53ha  
 Gross: 1.53ha

Legend  
 Net Area  
 Gross Area

Rev	Details	Date



Engineering Records Office,  
 London Stansted Airport,  
 Essex. CM24 1QW

Airport  
 London Stansted

Project Name  
 Stansted  
 Apron/ Airside Extensions

Title  
 35+ Airfield Infrastructure: Mike Romeo RET

Discipline  
 Planning

Project Phase  
 Planning

Drawing Originator  
 Stansted Airports

Originator's Job No.  
 001-002

Checked By  
 13/02/2018

Checked Date  
 13/02/2018

Drawn By  
 13/02/2018

Drawn Date  
 13/02/2018

Approved By  
 13/02/2018

Approval Date  
 13/02/2018

Scale and sheet size  
 1:1000 @ A1

Building Grid Reference

Owner  
 STAL

Originator  
 STAL

Project Ref.  
 001

Discipline  
 PLA

Drawing No.  
 001-002

Revision  
 01

